

Ordering Code: **ML-17A3-X-Y 01-Z**

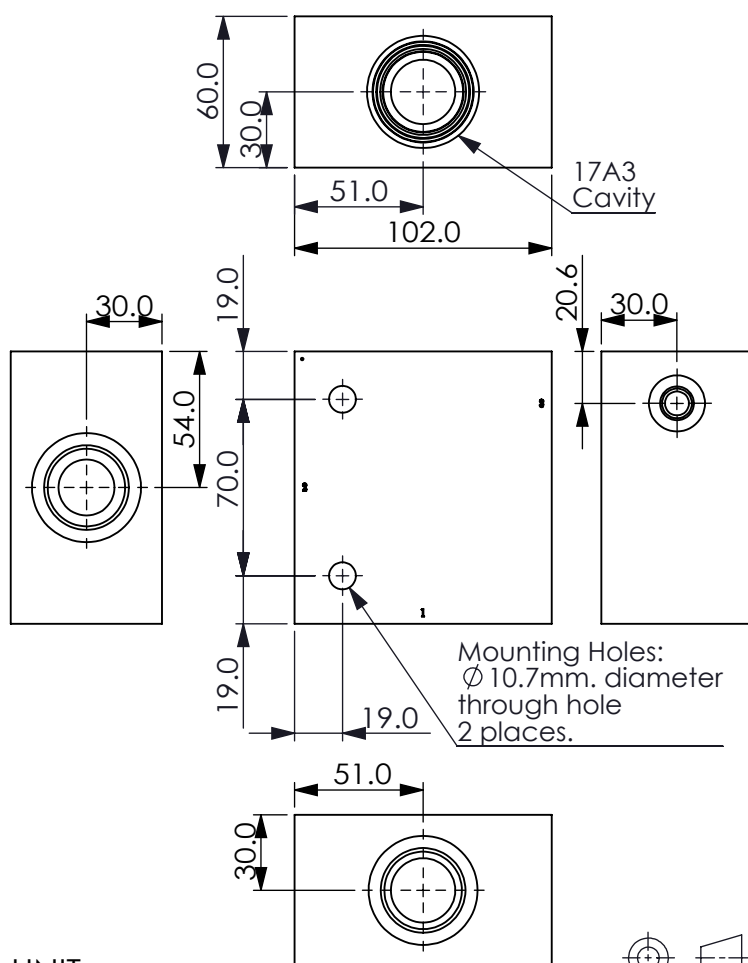

UNIT:mm

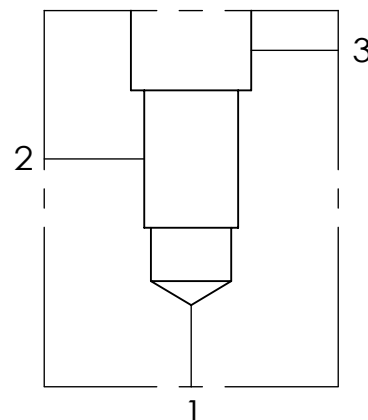

### TECHNICAL DATA

Aluminum Body Pressure Rating: 210 bar

Steel Body Pressure Rating: 350 bar

Cavity: Refer to 17A3

\* Refer to Winner Cartridge Valves Catalog.

Aluminum	1.5 kg(WITHOUT VALVES)
Steel	4.2 kg(WITHOUT VALVES)

\* If you need the special specification. Please contact us.

X	PORT SIZE		
	PORTS	PORT	
	1,2	3	
G06A	G 3/4"	G 1/4"	
G08A	G 1"	G 1/4"	
G10A	G 1-1/4"	G 1/4"	
S12A	SAE 12	SAE 6	
S16A	SAE 16	SAE 6	
P03	3/8"PT	3/8"PT	

Y	BODY MATERIAL	
A	HIGH-STRENGTH ALUMINUM	
T	STEEL (black oxide)	

Z	CARTRIDGE VALVES SELECTION
	WITHOUT VALVE
RV0A	RV17A30AL (240LPM,7-210bar)
CBCH	CB17A3CHL (3:1,70-280bar)
CO20	CO17A3020N (240LPM,2.0bar)
CC20	CC17A3020N (320LPM,2.0bar)
PB0A	PB17A30AL (160LPM,7-210bar)
Please refer to the list price of cartridge program.	